

Frame Installation *Drywall application*

TOOLS NEEDED: Tape measure, level, flathead & phillips screwdrivers, pencil

WHAT'S IN THE BOX: (5) sets of frame sticks labeled **TOP**, **BOTTOM**, **LEFT**, **RIGHT**, (20) corner clips, (80) drywall anchors, (80) screws

STEP 1: Slide a corner clip into the left and right side of the **TOP** frame stick. Tighten the screws against the metal backplate of the frame.

STEP 2: Using a level, draw a line where you would like the top stick to be. Mark the location of the holes with a pencil. Using a screwdriver, insert drywall anchors where you marked your holes. After drywall anchors are set into the wall place the frame on top aligning the holes and attach the **TOP** frame stick to the wall using the screws.

STEP 3: Install the **LEFT**, **RIGHT**, **BOTTOM** sticks using only the corner clips. Do not screw it to the wall in this step.

STEP 4: Using a level, make sure the frame is plumb. Adjust corner clips if needed. Mark your holes with a pencil. Then, by only loosening the corner keys in the top corners, remove the bottom 3 sticks as one unit. It resembles a "U" shape.

STEP 5: Install the drywall anchors where you marked the holes.

STEP 6: Slide the bottom 3 stick "U" shape back in and tighten the top corner clips.

STEP 7: Insert the remaining screws.

Not all steps have corresponding photos as reference.

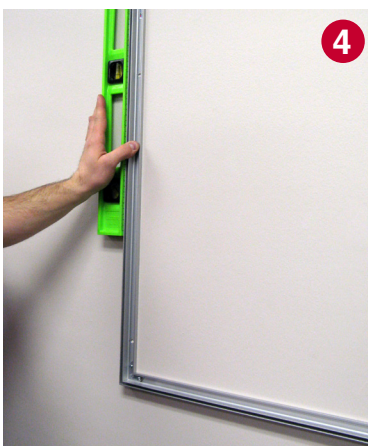
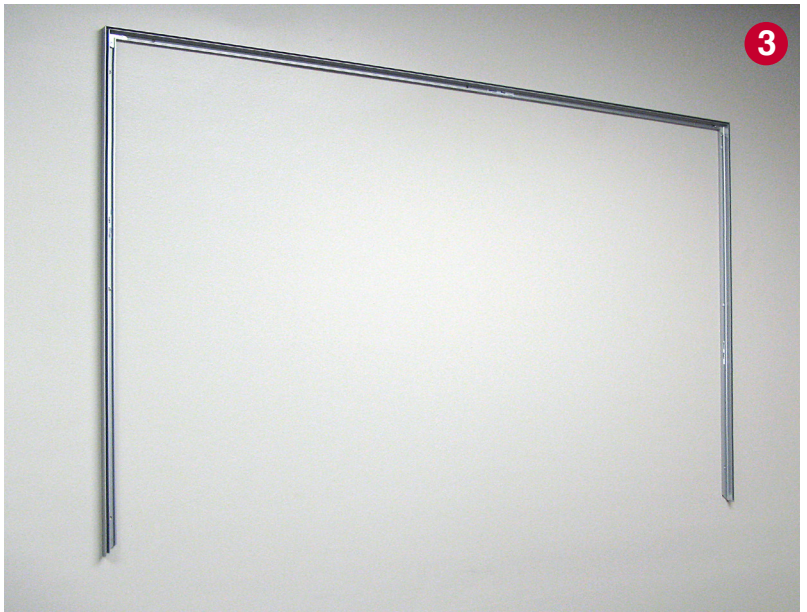
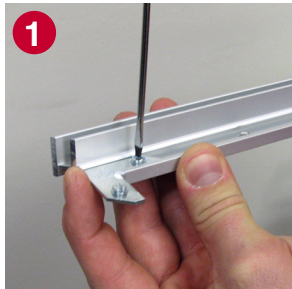

Tip: Adjust corner clips if needed to achieve plumb corners before marking holes for anchors.